

## GATE WITH VENTILATOR

### IN SET

### ASSEMBLY INSTRUCTION



x 1

built-in fan



x 4/8\*

extraction ropes

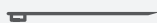

x 8

eyelet pins



x 4/8\*

anchors



x 1

mounting hammer



x 1

transport bag

\*depending on gate size.

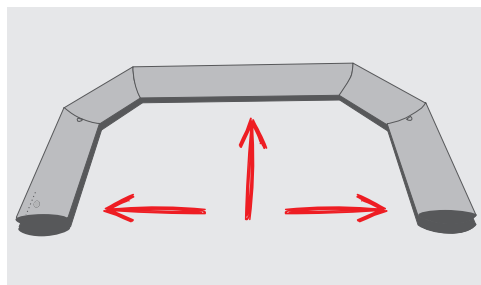

- 1 Unfold and stretch the gate to its full length with a fan on top. If possible use a sheet to protect the cover from dirt.

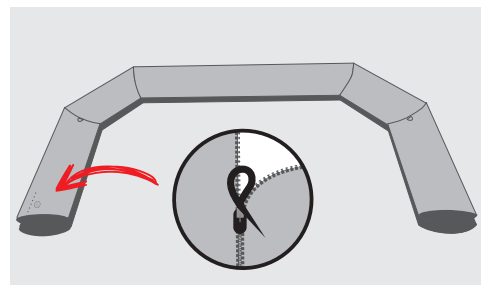

- 2 Fasten the lock next to the fan at the base of the gates on both sides.

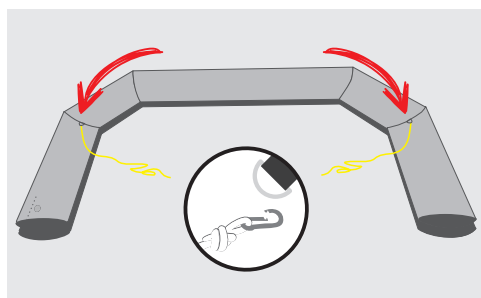

- 3 Attach the cables to the lashing eyes in the gate using snap hooks.

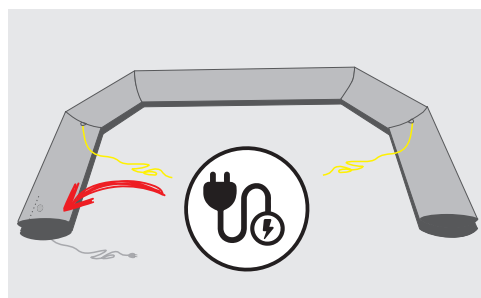

- 4 Connect the gate to the power supply and wait until it fills with air. Remember not to obstruct the fan inlet when inflating.

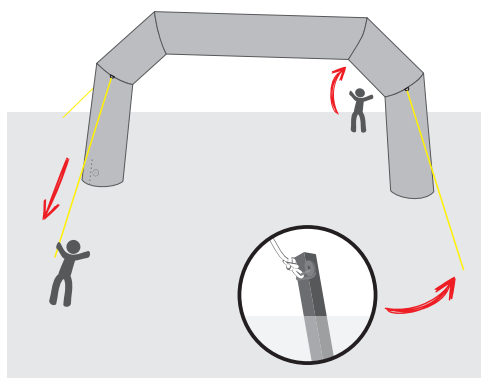

- 5 Stand the gate up slowly using the cables, then fix it to the ground with anchors using a hammer. The lashing lines should be taut and stretched to their full length.

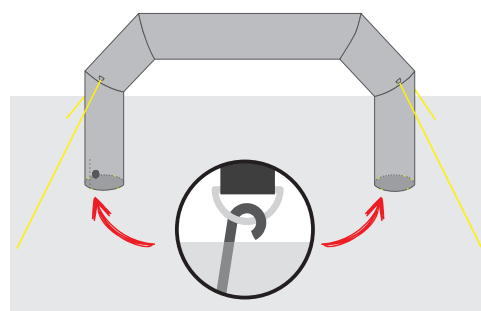

- 6 Stabilise the gate by hammering pins into the ground for the lashings at both its bases.

**!** For substrates that prevent the use of pins/anchors, dedicated elliptical gate weights should be used.

## GATE WITH VENTILATOR

### IN SET



x 1

built-in fan



x 4/8\*

extraction ropes

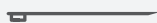

x 8

eyelet pins

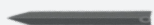

x 4/8\*

anchors



x 1

mounting hammer



x 1

transport bag

### DISASSEMBLY INSTRUCTION

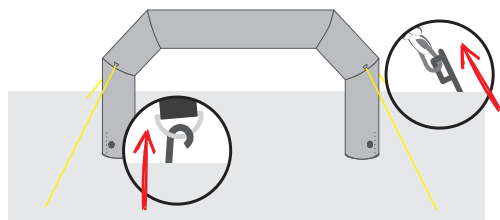

- 1 Remove all anchors/pins from the lashing lines and bases.

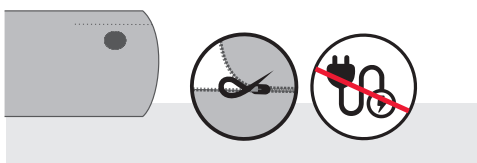

- 3 Unplug the product and undo the lock next to the fan in the base. This will start to release air from the product.

- 5 Assemble and pack the mounting kit in the accessory bag.

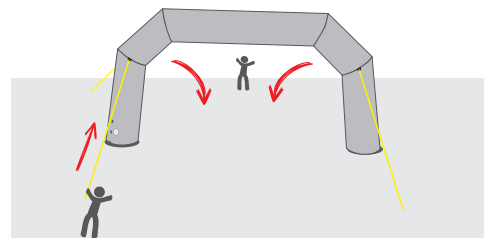

- 2 Slowly lay the product on a flat and dry surface using the lines. If possible, use a protective sheet.

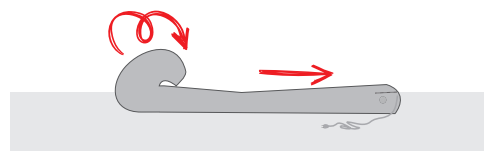

- 4 Wait until all the air has escaped from the product. Fold the gate in half and start slowly rolling the product towards the fan.

- 6 Pack the product and accessories in a dedicated carry bag.

### INSTRUCTION OF USE

1. Please read the product assembly/disassembly instructions before assembly.
2. When transporting, setting up and assembling the product, take special care to avoid damage to the product or injury during assembly.
3. Before disassembling the product, ensure that there are no sharp objects, tools, etc. with sharp edges in the area where the product will be assembled.
4. Check the condition of the electrical cables before connecting to avoid electric shock.
5. Do not obstruct the fan. The product should be positioned so that the ventilation hole has free access to air.
6. To avoid tripping hazards, the extraction cords should be positioned outside the passageways. If the lashings have to cross passageways or are close to passageways, they must be clearly marked (e.g. with warning tape).
7. During increasing gusts of wind, the seating of the pins/anchors must be checked systematically. In winds above 38km/h, the product must be assembled immediately.
8. During rain or snowfall, excess water/snow should be systematically removed from the product.
9. Any soiling must be removed immediately with a damp cloth and warm water without using detergents. The use of high-pressure cleaners is prohibited.
10. The product should be cleaned and dry before disassembly. If, due to weather or other circumstances, the product is assembled wet and dirty, it should be disassembled again as soon as possible, dried and cleaned.
11. The product should be stored in a dry and clean place.



risk of ignition following contact with a fire or ignition source



risk of entanglement or tripping over lashing ropes



risk of overturning due to incorrect installation or strong winds



inappropriate use e.g. climbing



risk of damage to the power cable, e.g. on an electric pump

\*depending on gate size.