

CONSTANT PRESSURE GATE VENTO®

MOUNTING SET



x 1
electric pump



x 4
straight pin with eyelet
and extraction ropes

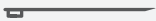

x 8
straight pin
with eyelet

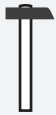

x 1
hammer

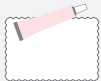

x 1
repair
set



x 1
built-in
cover

ASSEMBLY INSTRUCTION

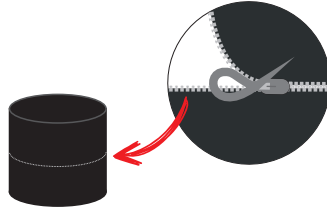

1 Unzip the lock connecting the bases.

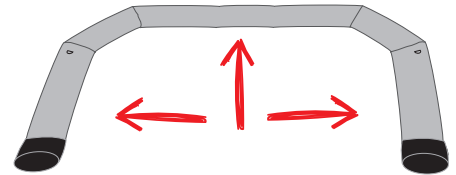

2 Spread the gate out on a flat, clean surface.

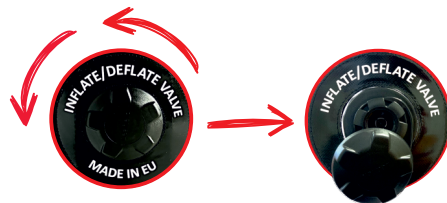

3 Find the inflate/deflate valve and unscrew the cap.

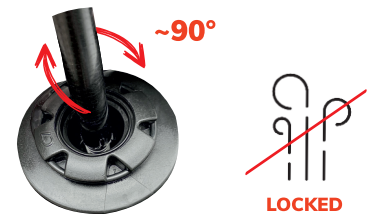

4 Lock the valve by turning the needle of the diaphragm about 90° to the right, this prevents the escaping of air. Unlock the valve to pump out air by turning the needle about 90° to the left.

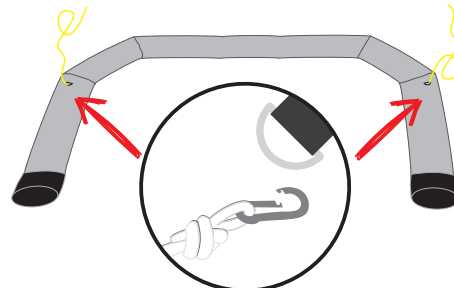

5 Pin the cables to the lashing eyes in the gate.

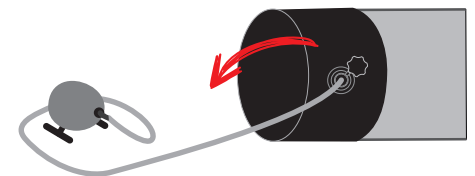

6 Start inflate with air using the supplied electric pump with dedicated tip.

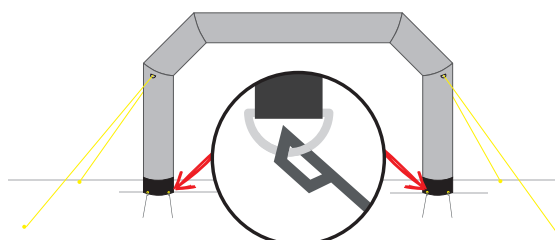

7 Put up and stabilize the gate using the lashing ropes. Fix the gate legs with pins to the ground.

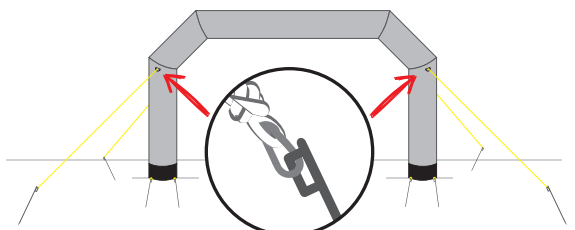

8 Fix the lines to the ground with pins. The lashing lines should be tensioned and stretched to their full length. For substrates that do not allow the use of pins/anchors, use dedicated weights for the lashing lines.

CONSTANT PRESSURE GATE VENTO®

MOUNTING SET



x 1
electric pump



x 4
straight pin with eyelet
and extraction ropes

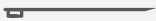

x 8
straight pin
with eyelet

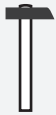

x 1
hammer



x 1
repair
set



x 1
built-in
cover

DISASSEMBLY INSTRUCTION

1 Remove all anchors/pins from the lashing lines.

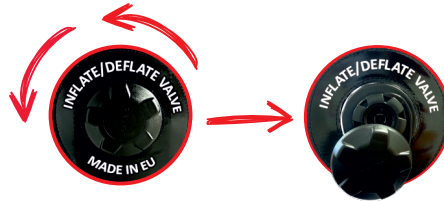

3 Find the inflate/deflate valve and unscrew the the plug.

2 Place the product on a flat and dry surface.

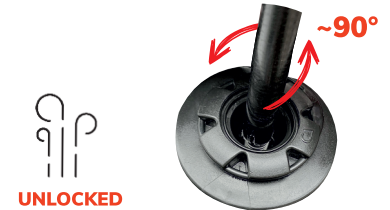

4 Unlock the valve by turning the diaphragm needle approximately 90° to the left and start pumping air out of the product.

5 Assemble and pack the mounting kit in the accessory bag.

6 Roll the product towards the inflate/deflate valves into a built-up bag or pack it into a dedicated carry bag and zip it up.

INSTRUCTION OF USE

1. Please read the product assembly/disassembly instructions before assembly.
2. When transporting, setting up and assembling the product, take special care to avoid damage to the product or injury during assembly.
3. Before disassembling the product, ensure that there are no sharp objects, tools, etc. with sharp edges in the area where the product will be assembled.
4. If using an electric pump, check the condition of the wires before connecting to avoid electric shock.
5. Do not cover the safety valves that regulate the air pressure in the product.
6. In case of very strong winds, systematically check the seating of the pins/anchors, when it blows more than 38km/h the product should be assembled immediately.
7. During rain or snowfall, excess water/snow should be systematically removed from the product.
8. Any soiling must be removed immediately with a damp cloth and warm water without the use of detergents. The use of high-pressure cleaners is prohibited.
9. The product should be cleaned and dry before disassembly. If, due to weather or other circumstances, the product is assembled wet and dirty, it should be disassembled again as soon as possible, dried and cleaned.
10. The product should be stored in a dry and clean place.



risk of ignition following contact with a fire or ignition source



risk of entanglement or tripping over lashing ropes



risk of overturning due to incorrect installation or strong winds



inappropriate use e.g. climbing



risk of damage to the power cable, e.g. on an electric pump