

## CONSTANT PRESSURE GATE VENTO®

### MOUNTING SET



x 1  
electric pump



x 4  
straight pin with eyelet  
and extraction ropes

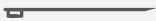

x 8  
straight pin  
with eyelet

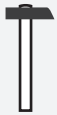

x 1  
hammer

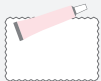

x 1  
repair  
set



x 1  
built-in  
cover

### ASSEMBLY INSTRUCTION

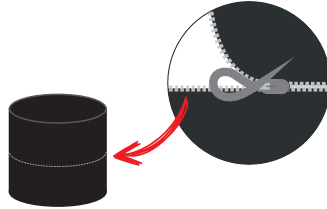

1 Unzip the lock connecting the bases.

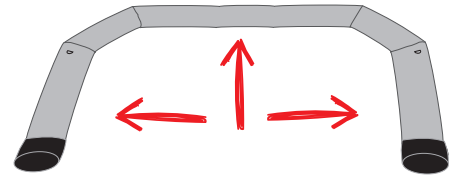

2 Spread the gate out on a flat, clean surface.

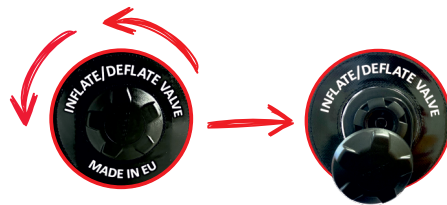

3 Find the inflate/deflate valve and unscrew the cap.

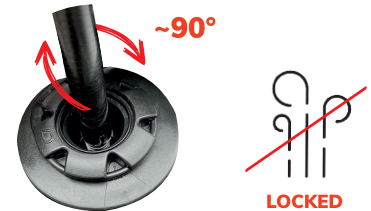

4 Lock the valve by turning the needle of the diaphragm about 90° to the right, this prevents the escaping of air. Unlock the valve to pump out air by turning the needle about 90° to the left.

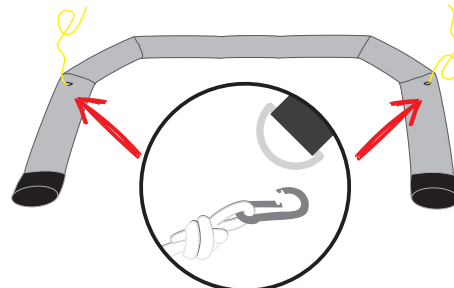

5 Pin the cables to the lashing eyes in the gate.

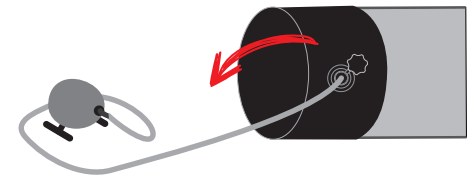

6 Start inflate with air using the supplied electric pump with dedicated tip.

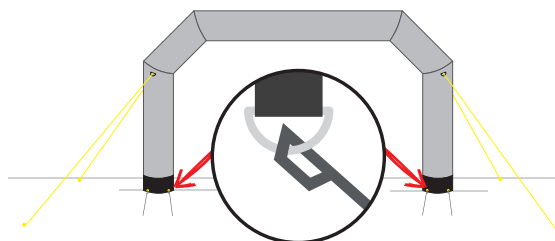

7 Put up and stabilize the gate using the lashing ropes. Fix the gate legs with pins to the ground.

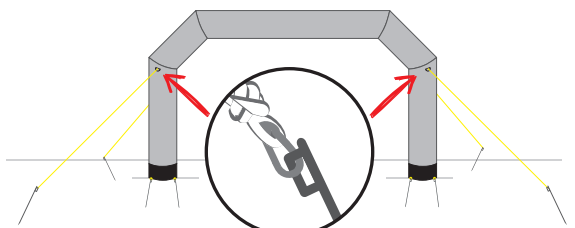

8 Fix the lines to the ground with pins. The lashing lines should be tensioned and stretched to their full length. For substrates that do not allow the use of pins/anchors, use dedicated weights for the lashing lines.